

RING SIZE GUIDE

MEASURE WITH STRING OR PAPER

1. Wrap string or paper around the base of your finger.
2. Mark the point where the ends meet with a pen.
3. Measure the string or paper with a ruler (mm).
4. Pick the closest measurement on the ring size chart to find your ring size.

MEASURE WITH ANOTHER RING

1. Select a ring that properly fits the intended finger.
2. Place the ring over the circles below.
3. Match the inside edge of the ring to the circle nearest in size.
This measurement refers to the inside diameter of the ring.
4. If the ring falls between two sizes, order the larger size.

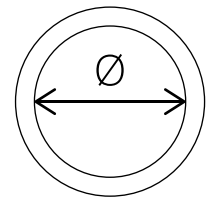

MEASUREMENT TIPS

- The ring should fit your finger comfortably: snug enough so it won't fall off, but loose enough to slide over your knuckle with relative ease.
- When the knuckle is bigger than the base of the finger, measure both places and pick a size in between the two.
- Measure your ring size at the end of the day when your fingers are warm. Finger size changes depending on the time of day and the weather, and your fingers are actually smaller in the early morning and in cold weather. Also, keep in mind that fingers on your dominant hand are usually larger.
- Measure 3 to 4 times for more accuracy.

RING SIZES

